

“ V i s t a ” B l o c k



“ V i s t a ” B l o c k

Vista Block

After careful consideration of the six alternatives for the “vista” block, the team determined that alternatives five and six embody the concepts consistent with the overall plan recommendations developed by the R/UDAT team for downtown Springfield. Both alternatives retain the buildings on the north side of the Old State Capitol Square and suggest infill structures for the north half of the “vista” block. The infill development should contain retail, commercial and residential structures that complement the Abraham Lincoln Presidential Library and Museum (ALPLM). The remaining one half-block directly south of Jefferson Street should be developed as a park or infill to be part of the gateway experience to the city and the ALPLM.

The reasons for this decision are as follows:

1. There are way too many holes in the historic fabric of the city’s downtown to create another one.
2. The other buildings in this block are 19th century buildings in good condition.
3. The National City Bank building, built in 1975, is an excellent example of modern architecture designed by Skidmore Owings and Merrill. It could be declared an historic building.
4. Razing the block would result in the loss of significant property tax revenue.

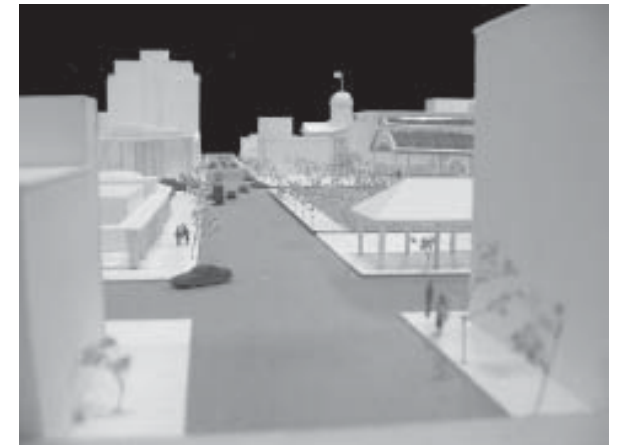
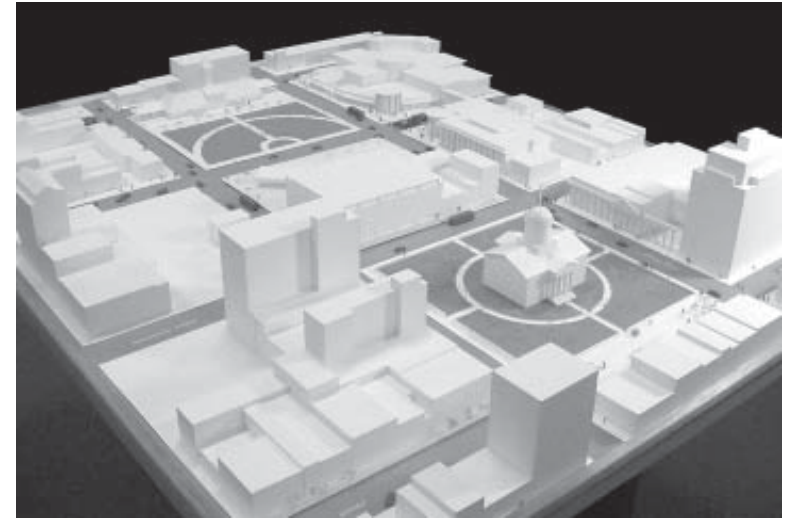

“ V i s t a ” B l o c k

1

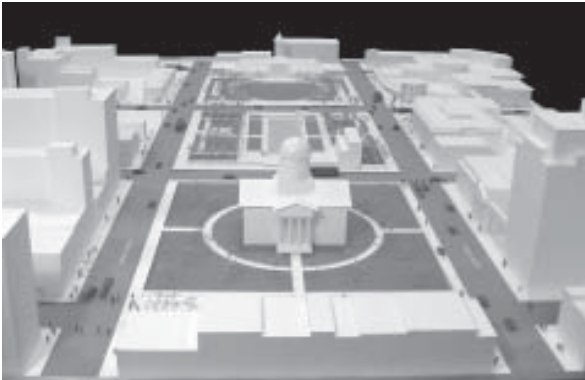

2

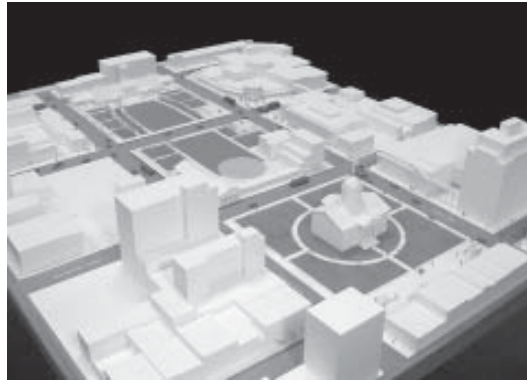

3

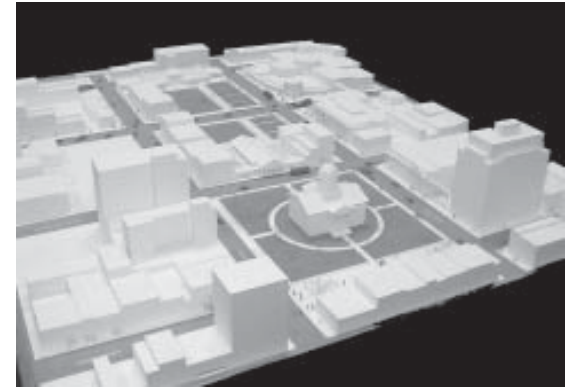

4

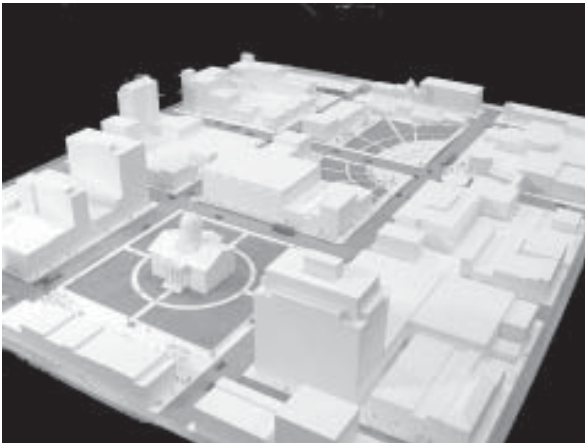

5

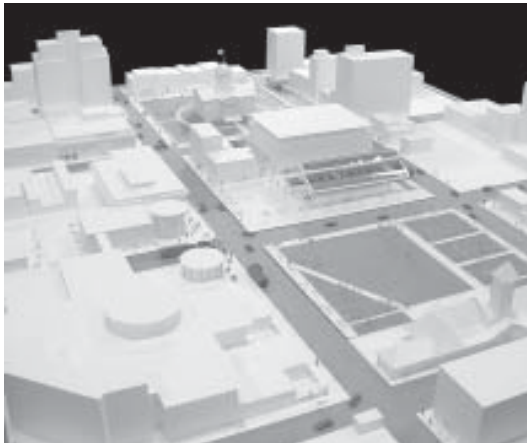

6

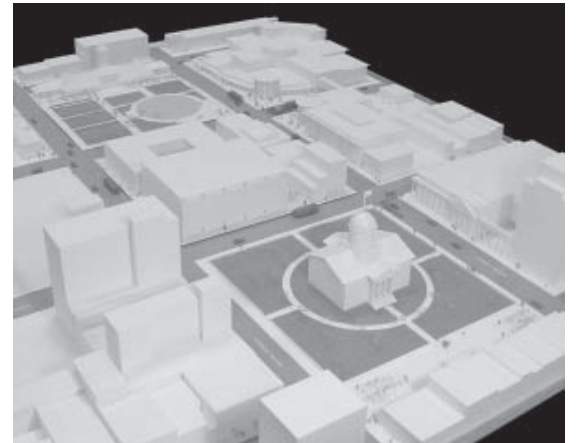



*Infill mixed use development at Jefferson and 6th.
...new development maintains historic scale and
enclosure along Jefferson*